

#### A milestone of design REAL SANDSTONE

the environment- friendly and procedure has made it possible for the first time to slice sandstone from stone blocks in thin layers of just 2-3 mm. The resulting Lightweight Sandstone is incomparably light, weighing just 5 kg/m<sup>2</sup> Ideal for any building project. Special base layers render Lightweight Sandstone mouldable and make it decidedly practical for further processing. It can be perfectly adapted to any perceivable shape - curves, domes, depressions or edges continuous and joint less



#### Application range

Sandstone Light - a rock for any occasion With Lightweight Sandstone all wishes come true: the design possibilities are endless, because of very good environmental compatibility Lightweight Sandstone can be used anywhere - and the processing is conceivably simple. Use Lightweight Sandstone for surfaces and mouldings.

#### Advantage

Sandstone Light weighs only 4 kg pro m<sup>2</sup> Sandstone Light boards can be used without special training Pencil, cutter, wooden wedge, toothed spatula and a level are all the tools you need. Rounded walls can be refaced without problems Corners and edges are fitted with hot air (corner rails are unnecessary) No heavy tools and scaffolding.

#### In the living area

Doorways, hallways, staircases, work spaces, saunas, kitchens, bathrooms, living rooms, bed rooms, children's rooms, Business area Banks, offices, reception areas, gastronomy, hotels, conference centres, stores, indoor pools, wellness and saunas and many more. Processing (Flexible construction in its fairest shape) Use the creative possibilities of Sandstone Light and give your office or personal rooms that special something! Fast and easy:

**Whether you are a professional craftsman or a handyman - the processing of the flexible Sandstone boards is as exceptionally easy as the material itself. The restoration of a bathroom for instance can be done in a day - without noise or dust!**



Please visit our website on

[www.hilldrithinteriors.co.uk](http://www.hilldrithinteriors.co.uk)



Cutting stone with a knife

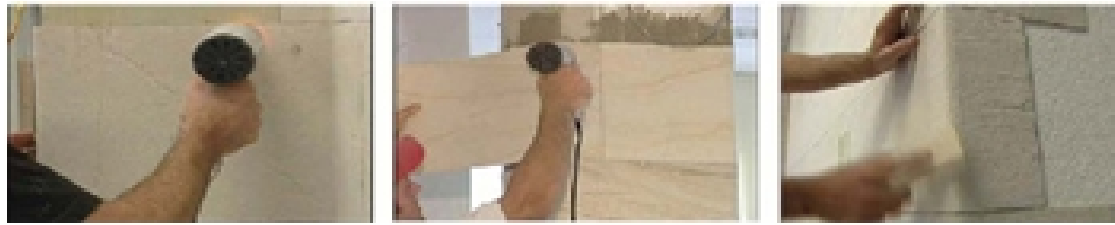

Heating and bending round corners and different shapes

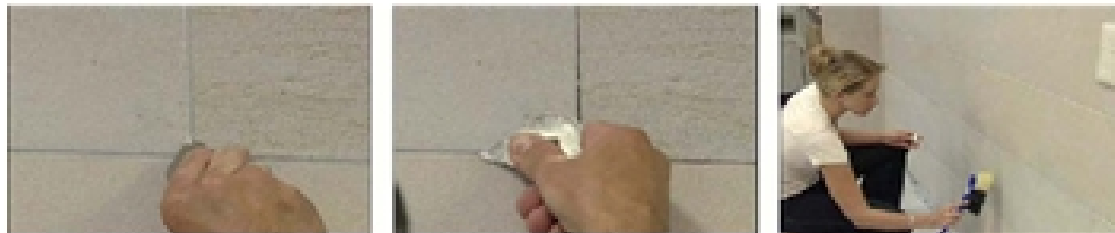

Finishing



Different colours, large sheets available. Interior walls

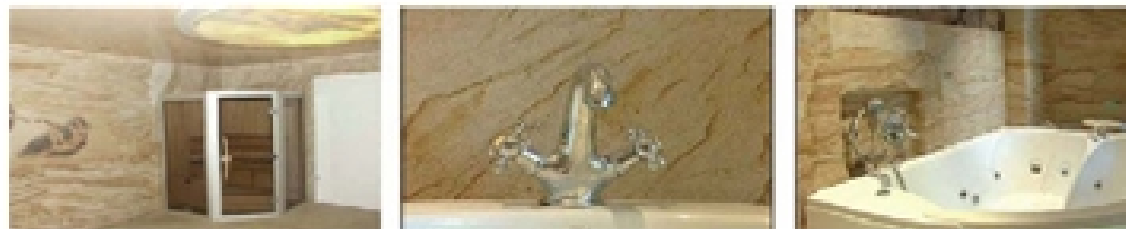

Bathroom complied water protection



Exterior Walls Façade available with graffiti protection

[www.hilldrithinteriors.co.uk](http://www.hilldrithinteriors.co.uk)

### **Sandstone Technical Data**

Sandstone Light has been scrutinized by independent experts of well-known institutes. The results comply with highest demands of the building industry:

#### **Inflammability classification**

DIN standard 4102, part 1, article 6.2  
DIN standard 4102, part 14  
B1 examined and certified  
Critical emission intensity > 1,1  
Integral value of light attenuation 0-0,7

#### **Castor chair effect**

DIN EN standard 425  
No visible alterations after 75.000 revolutions.

#### **Formaldehyde**

Sandstone Light is formaldehyde-free.

#### **Abrasion classification**

DIN 52368  
No visible alterations after 100.000 revolutions.

#### **Staining/cleaning**

DIN 51958 (EN 423)  
Sandstone Light is antistatic; wall cleaning is therefore unnecessary.

#### **Slip-resistance**

R 13 (inclination > 35°)  
Measurement performance  
DIN standard 434  
DIN standard 51967  
DIN standard 16860  
Manufacture alignment 0,14 mm  
Right-angled to manufacture alignment 0,05 - 0,17 mm  
Negligible measurement alterations 0,03 - 0,17 mm

#### **Peel resistance**

DIN standard 16860  
With normal climate and heating conditions 1,76 - 1,98 N/mm

#### **Heat transmission**

DIN standard 66098  
FlexSandStein  
is suitable for under  
floor heating.